

23/01457/OUT – Land Adjacent Laxton Leaze, Waterlooville, Hampshire

Outline application for residential development up to 69 dwellings with access in detail. All other matters reserved. (amended Plans Submitted, amended description)

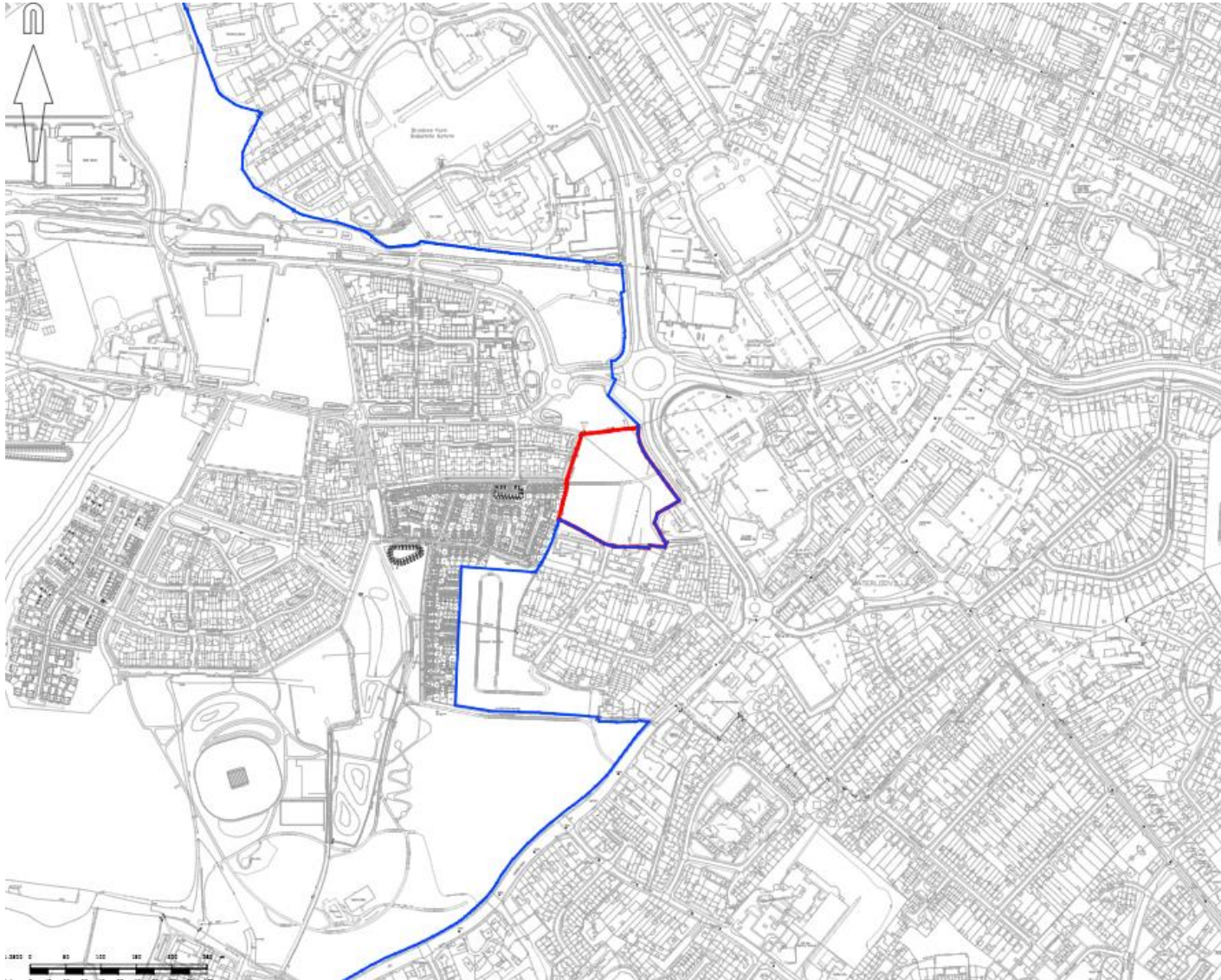

LOCATION PLAN



MAP SHOWING DISTRICT BOUNDARY

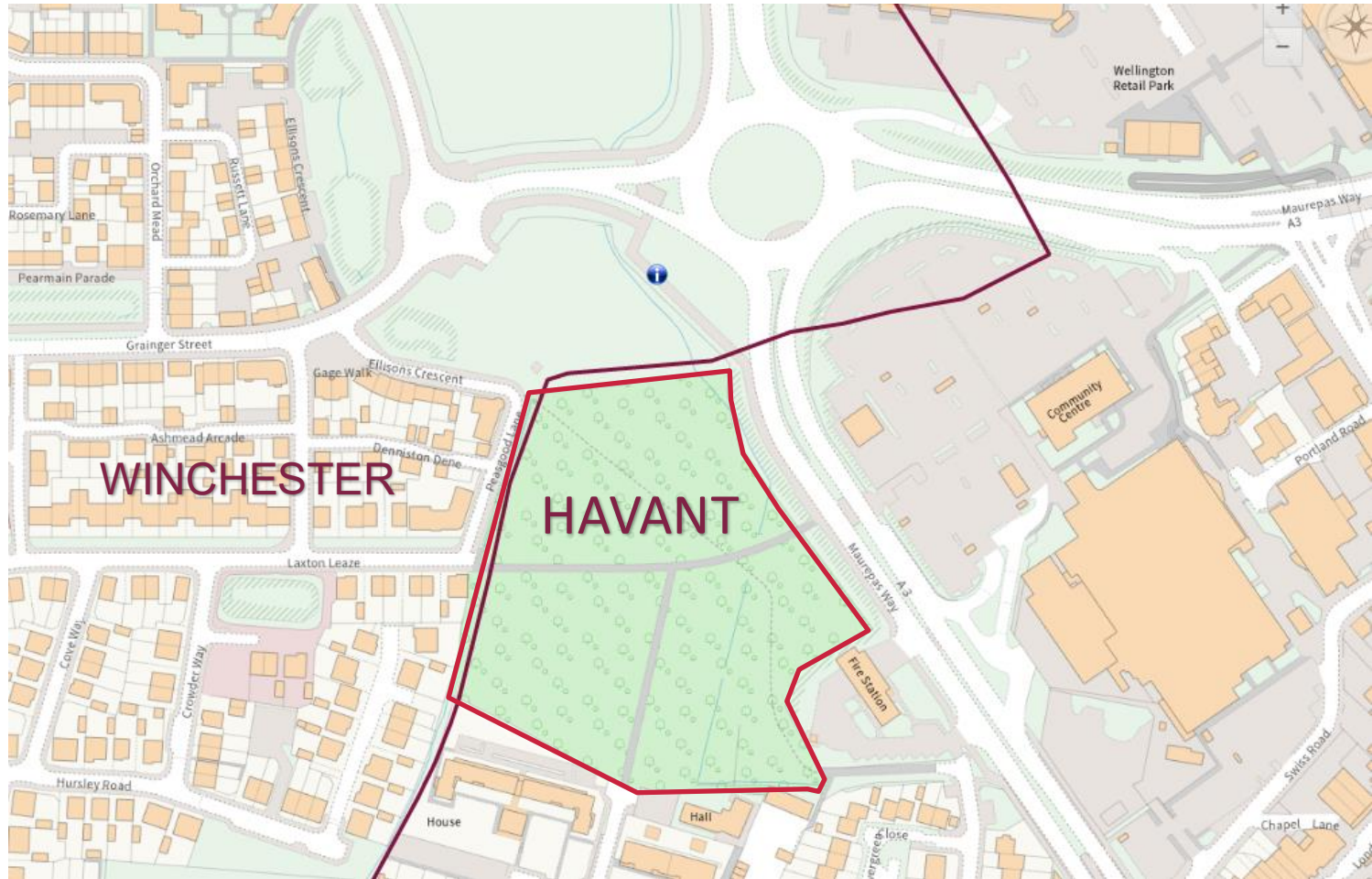

AERIAL PHOTOGRAPH



ILLUSTRATIVE MASTERPLAN



PROPOSED VEHICLE ACCESS

Tydeman House
1 to 6

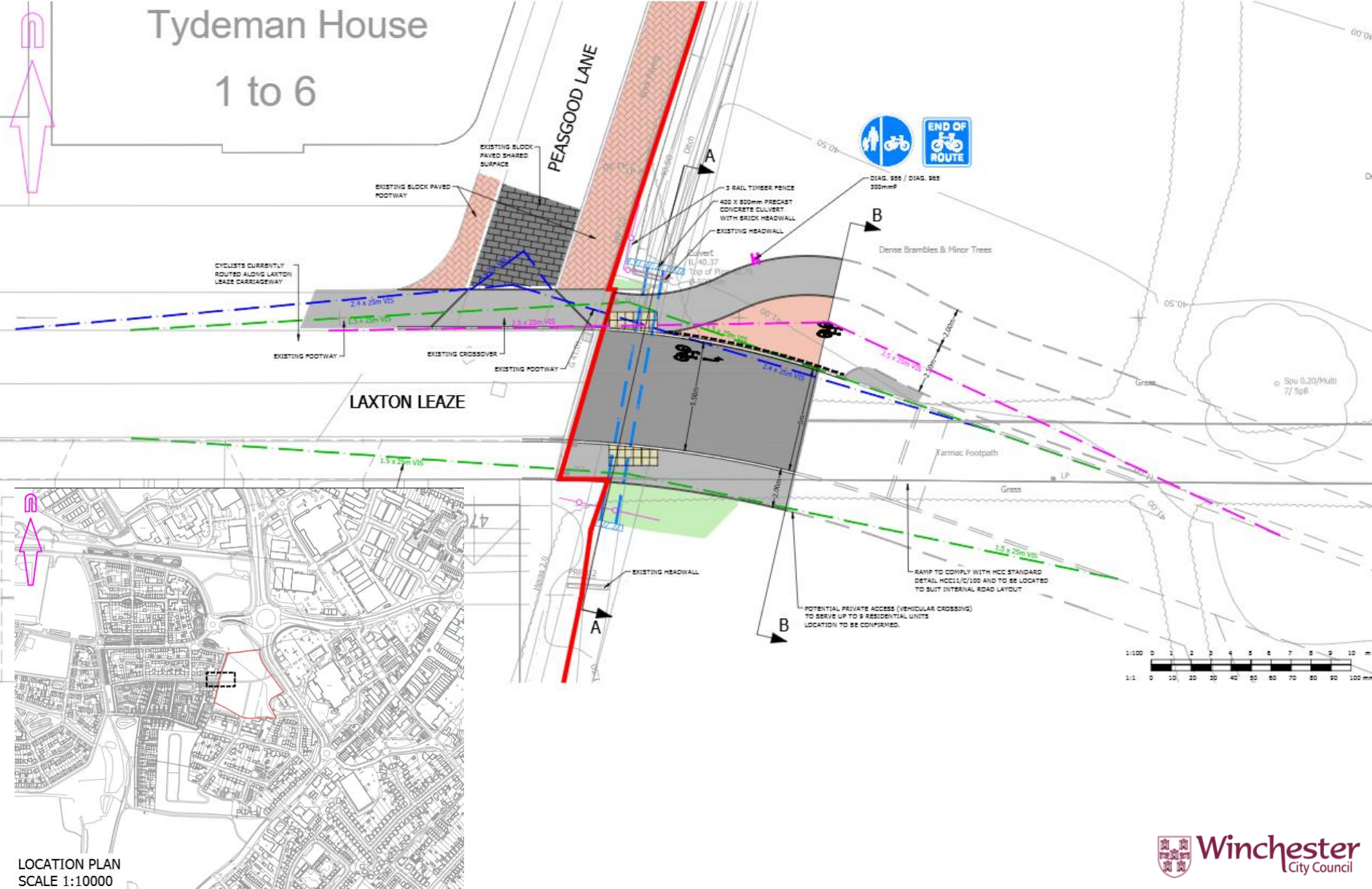

PROPOSED EMERGENCY AND PEDESTRIAN ACCESS

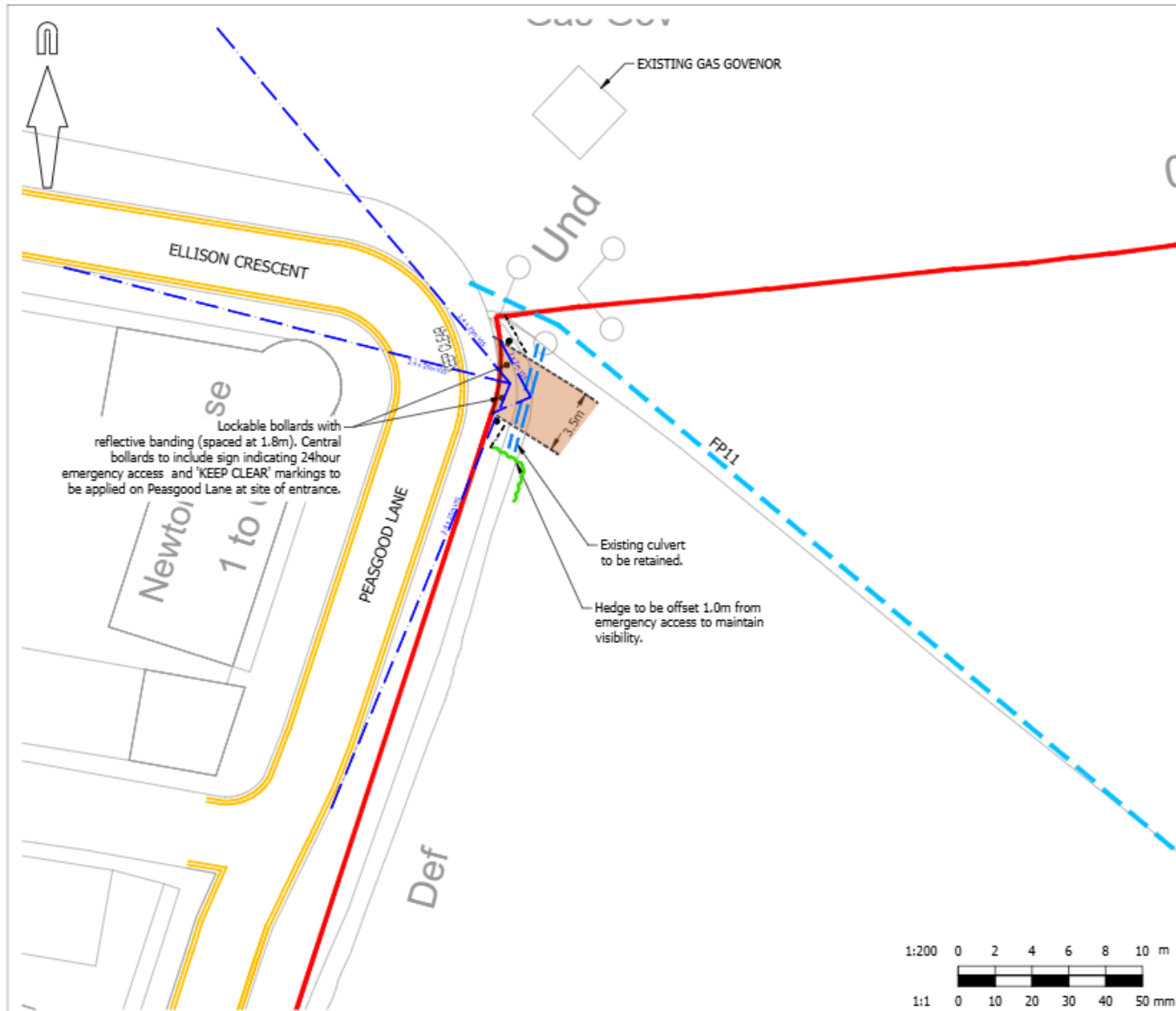

VEHICLE TRACKING

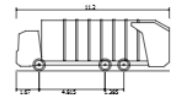
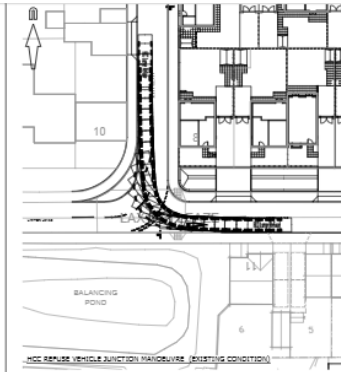
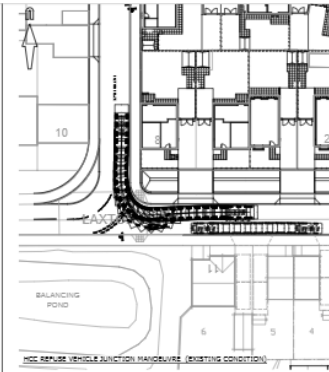
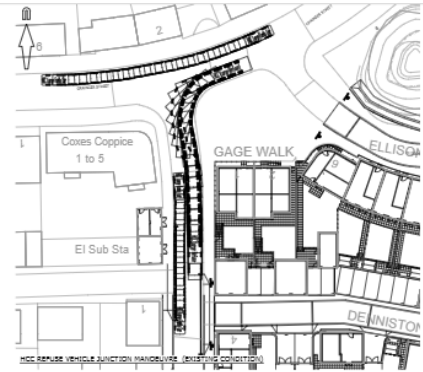

Phoenix 2 Duo (P2-15W with Elite 6v4 chassis)
 Overall Length 12.20m
 Overall Width 2.26m
 Overall Body Height 2.55m
 Min Body Ground Clearance 0.35m
 Track Width 2.50m
 Lock to lock time 4.0s
 Kerb to Kerb Turning Radius 9.500m

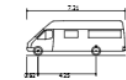
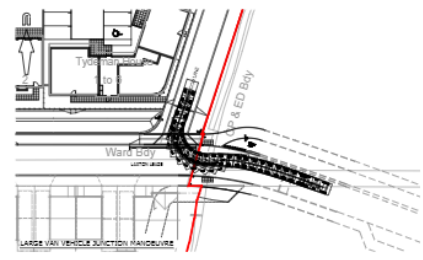

7.5t Panel Van
 Overall Length 7.21m
 Overall Width 2.24m
 Overall Body Height 2.54m
 Min Body Ground Clearance 0.35m
 Track Width 2.50m
 Lock to lock time 4.0s
 Kerb to Kerb Turning Radius 7.400m

VEHICLE TRACKING

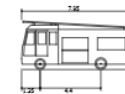
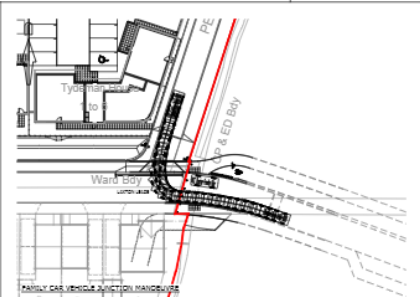
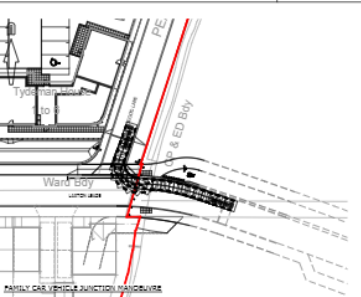
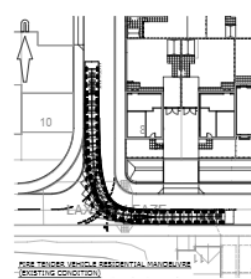
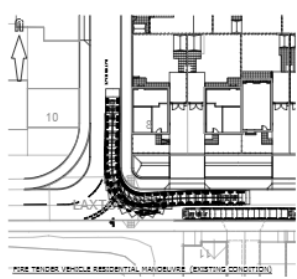
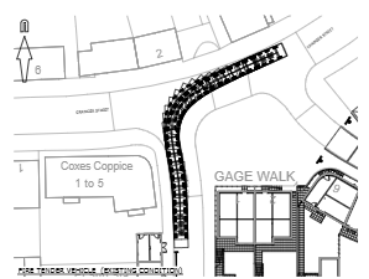
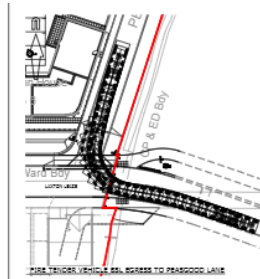
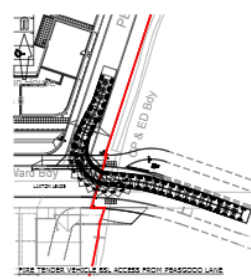
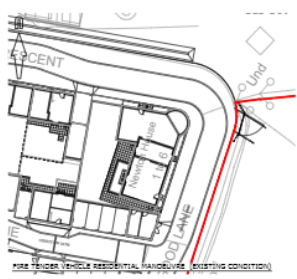
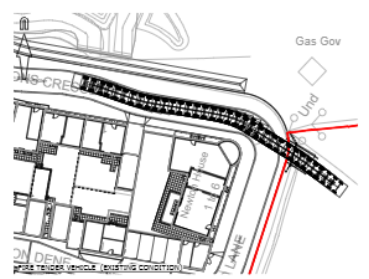

HCC FIRE PUMP

Overall Length	7.950m
Overall Width	2.500m
Overall Body Height	3.490m
Min Body Ground Clearance	0.380m
Max Track Width	2.000m
Lock to lock time	6.000s
Kerb to Kerb Turning Radius	7.750m



Standard Design Vehicle (SDV)

Overall Length	4.800m
Overall Width	2.000m
Overall Body Height	1.950m
Min Body Ground Clearance	0.100m
Track Width	2.000m
Lock to lock time	4.000s
Wall to Wall Turning Radius	6.000m

REFUSE VEHICLE TRACKING PEASGOOD LANE

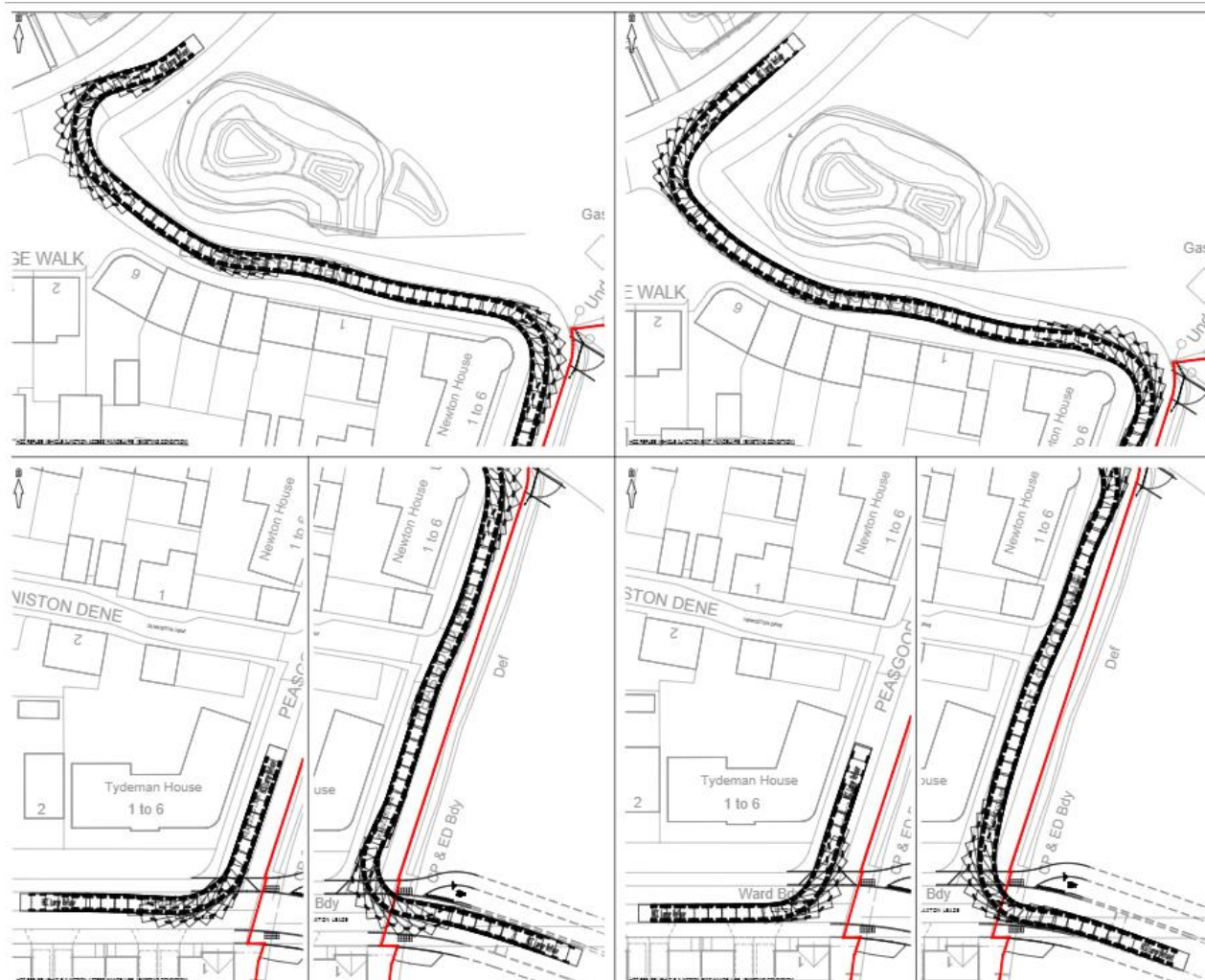

SITE PHOTOS



SITE PHOTOS



SITE PHOTOS



SITE PHOTOS



CONCLUSION

Recommendation: PERMIT